

PROPERTIES OF EAS GONIOMETER TSU

All definitions of the values and functions used see in the part «GONIOMETER'S GENERIC PROPERTIES»
 The TSU goniometer is disassembled since 2018.

I. Javakhishvili Tbilisi State University, Tbilisi, Georgia

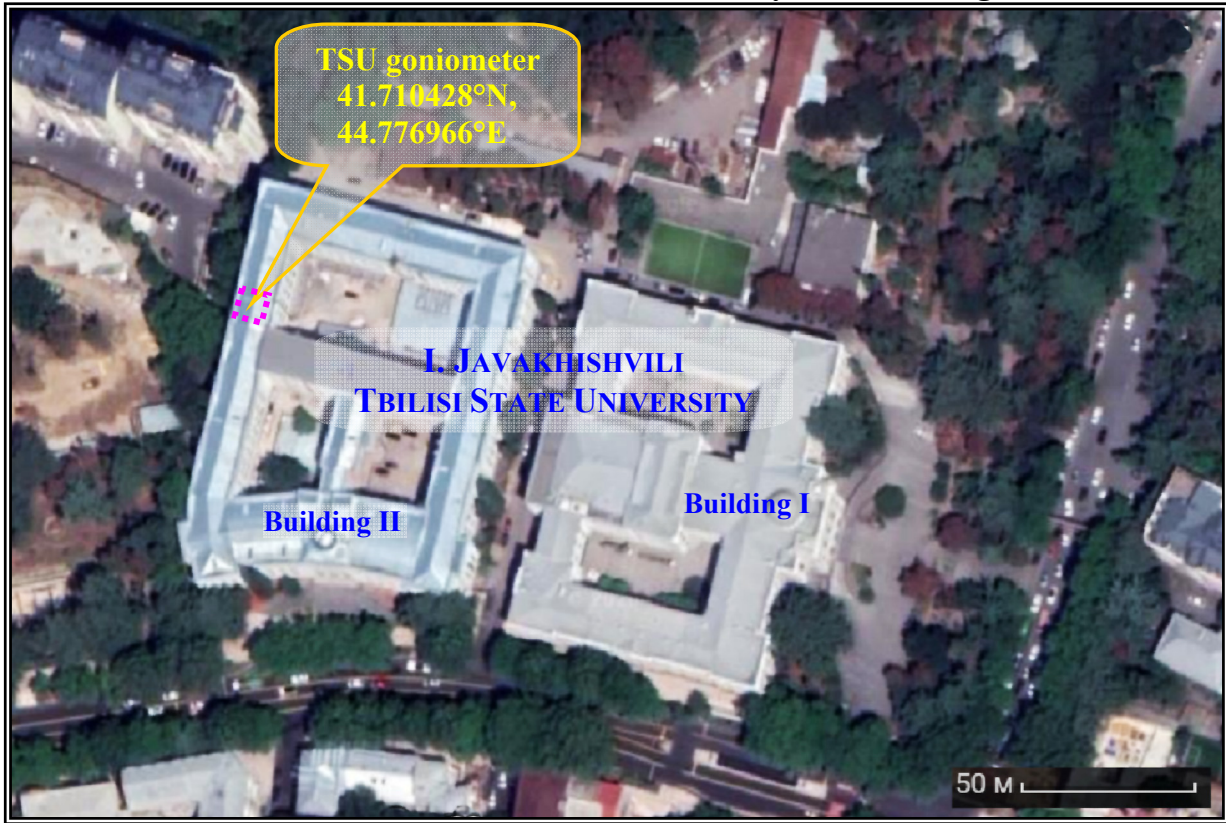

Location of the TSU installation,

Latitude	41.710426°N
Longitude	44.777002°E
Altitude	(474.5 ± 0.5)m above sea level
Upright atmospheric mass depth	$X_{TSU}^{\uparrow} = 979.0 \text{ g/cm}^2$
Air density at this location	$\rho_{TSU} = 1170 \text{ g/m}^3$
and the corresponding multiple scattering unit	$rM_{TSU} = 82.2m$

The “flat” detectors of the TSU goniometer are located under the iron roof of the second building of Tbilisi State University in Tbilisi. The mass depth of this filter is accepted to be $X_{\text{filter}} = 0.78 \text{ g/cm}^2$ for all directions and the radiation length for the actual absorber's substance (iron) is accepted to be $T_{\text{filter}} = 13.9 \text{ g/cm}^2$

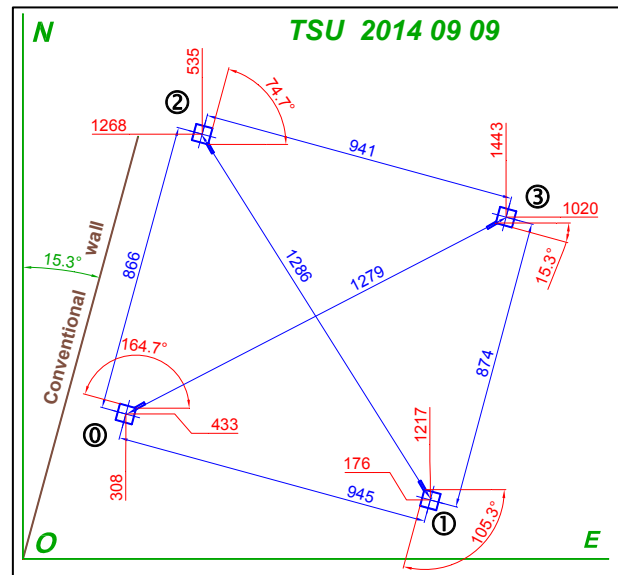

Figure 1 TSU array layout.
 All linear dimensions are measured in centimeters.

Number of detectors $N = 4$; $d = 0, 1, 2, 3$

The areas of all plastic scintillator slabs are $S_d = 0.25m^2$; $\{SS_{TSU}\} = (S_0, S_1, S_2, S_3)$

The detectors' positions layout in the roof space is shown in the **figure 1**.

Local $(E, N)^T$ coordinates of the detectors are obtained by two-dimensional multilateration procedure relative to the fixed points on the circumscribing walling with subsequent rotation by 15.3° about the vertical axis:

$$\{\mathbf{rr}_{\text{TSU}}\} = \begin{pmatrix} 308 & 1217 & 535 & 1443 \\ 433 & 176 & 1268 & 1020 \end{pmatrix} \text{cm} \begin{matrix} \text{"E"} \\ \text{"N"} \end{matrix}$$

The practically occurred EAS observation rate at AIP goniometer's performance during the 2017 year observation session is

$$\text{ExpRate}_{\text{TSU}} = (20.306 \pm 0.138) \text{ hr}^{-1}.$$

The required effective common threshold of sensitivity n_{AIP}^* of all detectors used is estimated by numerical solving of the equation

$$\widetilde{\text{Rate}}(n_{\text{TSU}}^*) = \text{ExpRate}_{\text{TSU}}$$

shown in the **figure 2**. Here $\widetilde{\text{Rate}}(n^*)$ is the interpolation polynomial curved upon the set of calculated rates for the series of arbitrarily assigned values n^* of supposed thresholds of sensitivity. The effective common threshold of sensitivity of all detectors is estimated as $n_{\text{TSU}}^* = 2.729$ particles per detector

Therefore the aggregate variable TSU describing the native properties of the TSU goniometer is established as $TSU = [X_{\text{TSU}}^\uparrow, \{\mathbf{rr}_{\text{TSU}}\}, \{\text{SS}_{\text{TSU}}\}, \{n_{\text{TSU}}^*\}]$. Every consequent calculation uses this set of properties.

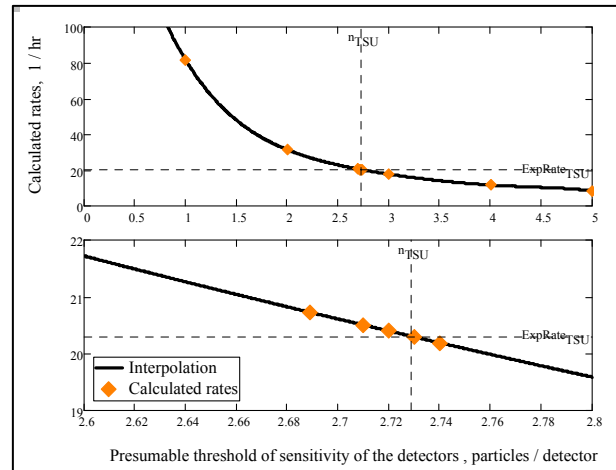

Figure 2 Plot of the numerical estimation of the effective common threshold of sensitivity of the detectors of TSU goniometer.

The properties evaluated

The calculated rate of EAS observations by TSU goniometer is $\text{Rate}_{\text{TSU}} = 20.306 \text{ hr}^{-1}$ while the observations rate is $\text{ExpRate}_{\text{TSU}} = (20.306 \pm 0.138) \text{ hr}^{-1}$.

The aperture function of the TSU goniometer

The estimated dependence of the TSU goniometer's aperture $^{(TSU)}\text{Ap}(E)$ on the showers' energy E is shown in the **figure 3**.

The lower energy threshold of the observable EAS events is

$$\begin{aligned} ^{(TSU)}E_{\text{thr}} &= 2.3 \times 10^5 \text{ GeV} \\ &= 2.3 \times 10^{14} \text{ eV} \end{aligned}$$

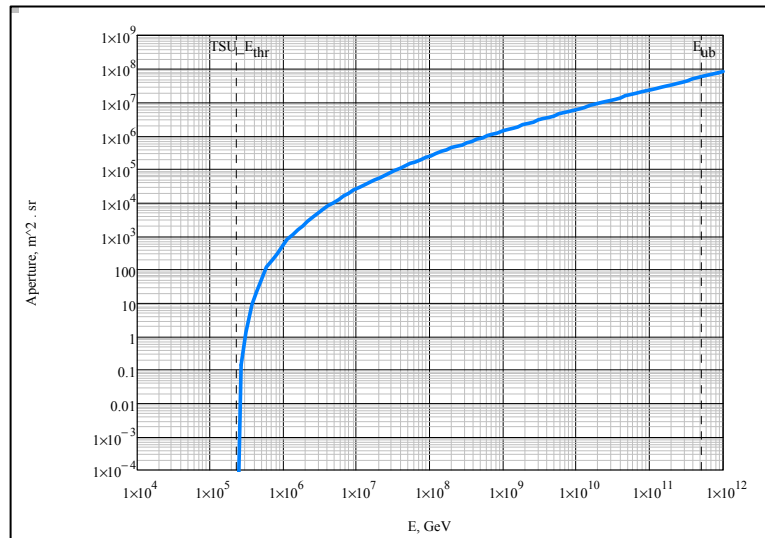

Figure 3. Dependence of the TSU goniometer's aperture on the showers' energy E

The probability density function of the EAS energies observable by the TSU goniometer

The estimated density function of the EAS energies E observable by the TSU goniometer $^{(TSU)}f_E(E)$ is shown in the **figure 4**.

The average energy of the observable showers is

$$\begin{aligned} ^{(AIP)}E_{av} &= 9.9 \times 10^6 \text{ GeV} \\ &= 9.9 \times 10^{15} \text{ eV} \end{aligned}$$

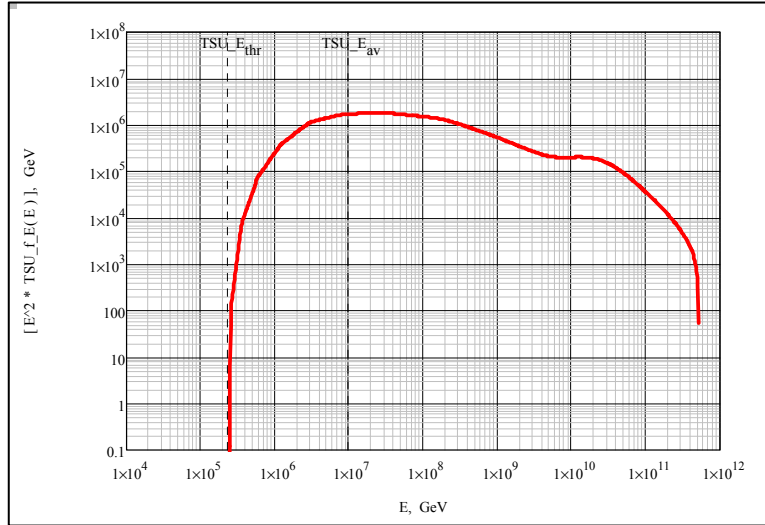

Figure 4. The EAS energy E distribution density for the TSU goniometer observations is shown. Density values are scaled by corresponding energy E in the power 2.0

The integral distribution function of the EAS energies observable by the TSU goniometer

The estimated total number of EAS events observable by TSU goniometer in the course of 1 year $^{(TSU)}F_E(E_{min})$ dependent on the minimal energy E_{min} of the showers' sampling part is shown in the **figure 5**.

Total rate of all showers observation is

$$\begin{aligned} ^{(TSU)}Rate_{tot} &= 177995 \text{ EAS/year} \\ &= 20.306 \text{ EAS/hr} \end{aligned}$$

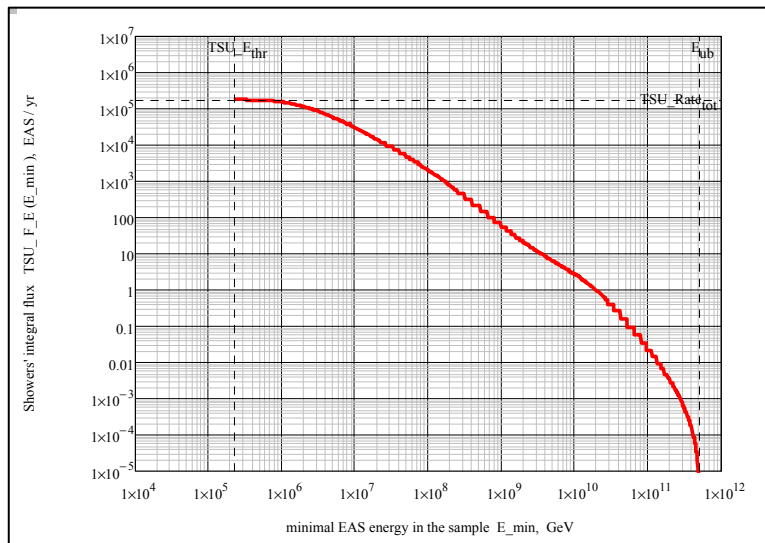

Figure 5. The curve shows the dependence on the sample minimal energy of total number of EAS events observable by TSU goniometer in the course of 1 year

The greatest accessible distance to the shower cores

The function $^{(TSU)}R_{\max}(E)$ of the greatest accessible distance to the shower cores is defined numerically at given energy. This function is shown in the **figure 6**.

This dependence is defined in the energy interval

$$^{(TSU)}E_{\text{thr}} < E < E_{\text{ub}}.$$

The maximal available distance is defined at upper bound of observable EAS energy

$$E_{\text{ub}} = 516 \text{ EeV} = 5.16 \times 10^{20} \text{ eV}$$

$$^{(TSU)}\text{max}R = ^{(TSU)}R_{\max}(E_{\text{ub}}) = 2944 \text{ m}$$

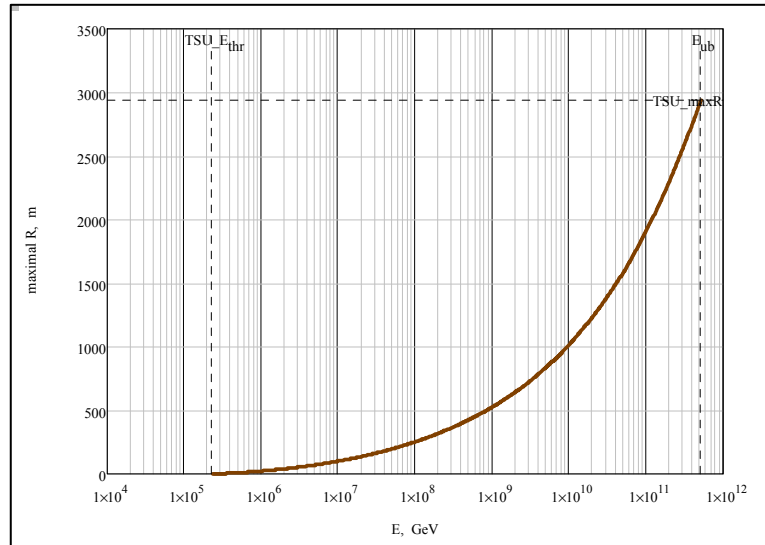

Figure 6. The energy dependence of the maximal distance from the TSU center to the EAS core intersection with the XY plane

The probability density function of the distances between the coordinate system origin and the EAS cores' points of intersection with the XY plane for the showers observable by the TSU goniometer

The probability density function $^{(TSU)}f_R(R)$ of the distances R to the cores of observable showers at TSU goniometer is shown in the **figure 7**.

This distribution is defined in the available distances interval

$$0 < R < ^{(TSU)}\text{max}R$$

$$^{(TSU)}\text{max}R = 2944 \text{ m}$$

The distance of most probable EAS observations is

$$^{(TSU)}R_{\text{mode}} = 39.1 \text{ m}$$

The average distance is

$$^{(TSU)}R_{\text{av}} = ^{(TSU)}\langle R \rangle = 112.6 \text{ m}$$

The root mean square distance is

$$^{(TSU)}R_{\text{rms}} = \sqrt{^{(TSU)}\langle R^2 \rangle} = 159.5 \text{ m}$$

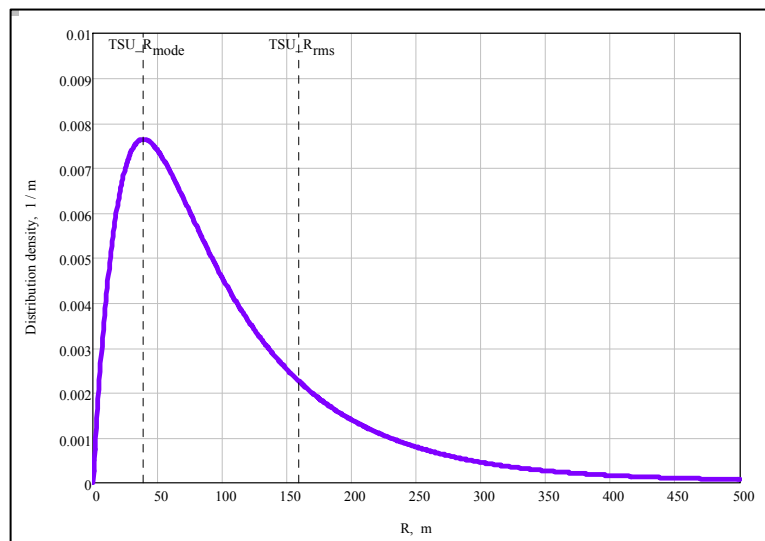

Figure 7. The distribution density of the EAS core distances R from the TSU goniometer center.

Two-dimensional distribution of the EAS core position points' observable by TSU goniometer

The diametrical section of two-dimensional distribution $^{(TSU)}f^{(2)}(x, y)$ of the EAS core position points' observable by TSU goniometer is shown in the **figure 8**.

The average position of all EAS cores' intersections with XY plane is obviously in the goniometer's center ($x = 0, y = 0$) and the standard deviation in each of (x, y) dimensions is equal to

$$^{(TSU)}\sigma R = \sqrt{^{(TSU)}\langle R^2 \rangle / 2} = 112.8m .$$

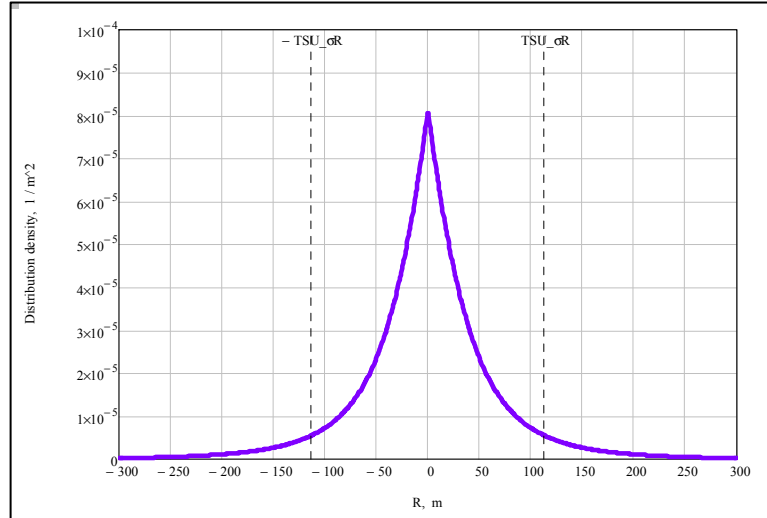

Figure 8. The diametrical section of the EAS core position points' distribution for the TSU goniometer observations.

Probability of the EAS core observation by the TSU goniometer at the distance less then R

The last probability is shown in the **figure 9**.

$$^{(TSU)}F_R(R) = \int_0^R ^{(TSU)}f_R(R') dR'$$

Approximately one-half fraction of the total number of EAS cores observable by the TSU goniometer are intersecting the XY plane within the distance of 81m, while the 90% part intersects within the 231m radius.

$$^{(TSU)}F_R(^{(TSU)}R_{mode}) = 21.3\%$$

$$^{(TSU)}R_{mode} = 39.1m$$

$$^{(TSU)}F_R(^{(TSU)}\sigma R) = 65.0\%$$

$$^{(TSU)}\sigma R = 112.8m$$

$$^{(TSU)}F_R(^{(TSU)}R_{av}) = 64.9\%$$

$$^{(TSU)}R_{av} = 112.6m$$

$$^{(TSU)}F_R(^{(TSU)}R_{rms}) = 79.1\%$$

$$^{(TSU)}R_{rms} = 159.5m$$

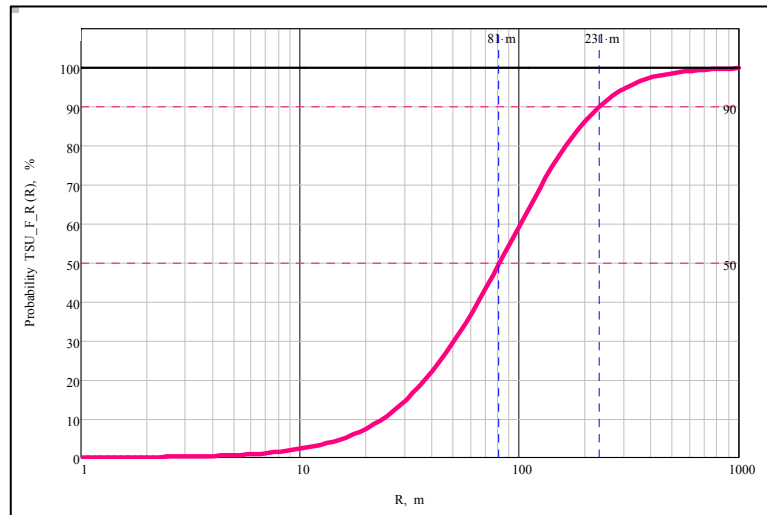

Figure 9. Probability of the EAS core observation by the TSU goniometer at the distance less then R

Borders of the areas of the observable vertical EAS cores' penetration for the TSU goniometer

Those borders are shown in the **figures 10 and 11** for some maximal EAS energies.

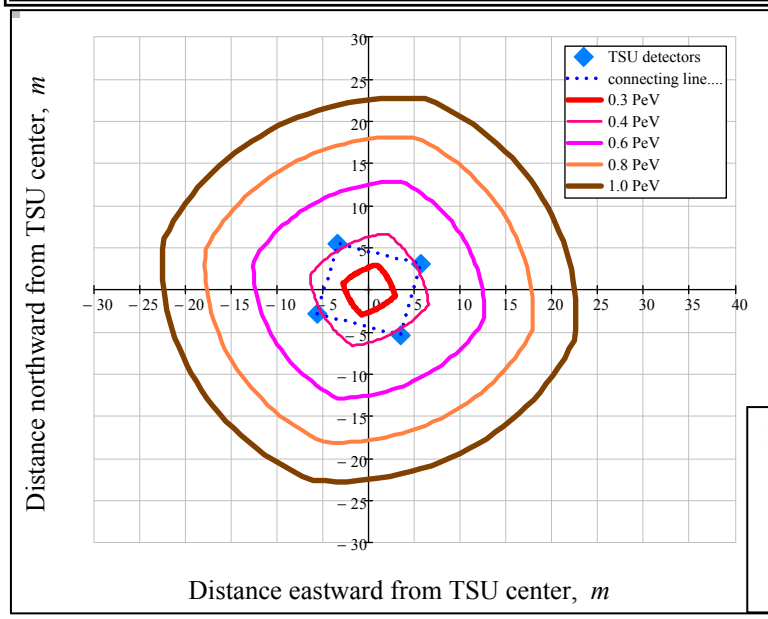
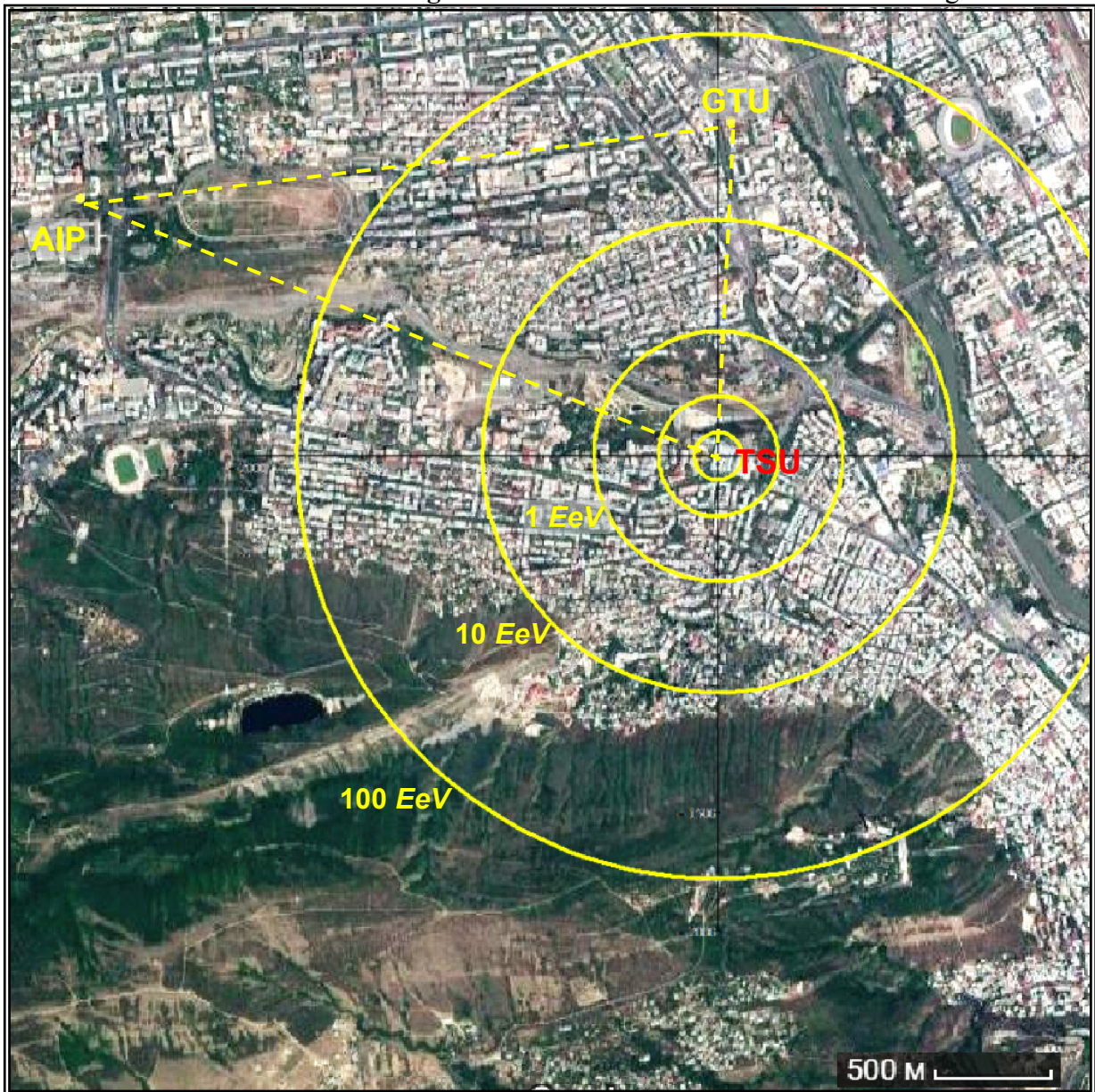

Figure 10 Borders of the areas of the TSU-observable vertical EAS cores' passage for the specified maximal total energies of the showers: 10PeV, 100PeV, 1EeV, 10EeV, 100EeV

Figure 11 Borders in the TSU vicinity of the areas of the observable vertical EAS cores' passage for the maximal total energies of the showers specified in the legend